

### TECHNICAL SPECIFICATIONS

### SERIES "S" MACHINE ROOM LESS

	MP610V	MP810V	MP616V	MP816V
P	6	8	6	8
V	1.0 m/s	1.0 m/s	1.6 m/s	1.6 m/s
AH	1600	1700	1600	1700
FH	1550	1700	1550	1700
AC	1000	1100	1000	1100
FC	1250	1400	1250	1400
CT	480	480	480	480
H	3600	3600	3800	3800
F	1200	1200	1400	1400
PL	800	800	800	800

#### LEGEND

- P Capacity (Passengers)
- V Speed (m/s)
- AH Shaft width
- FH Shaft depth
- AC Car width
- FC Exterior car depth
- CT Technological Dimension
- H Clear overhead
- F Pit
- PL Clear entrance

#### DIAGRAMS

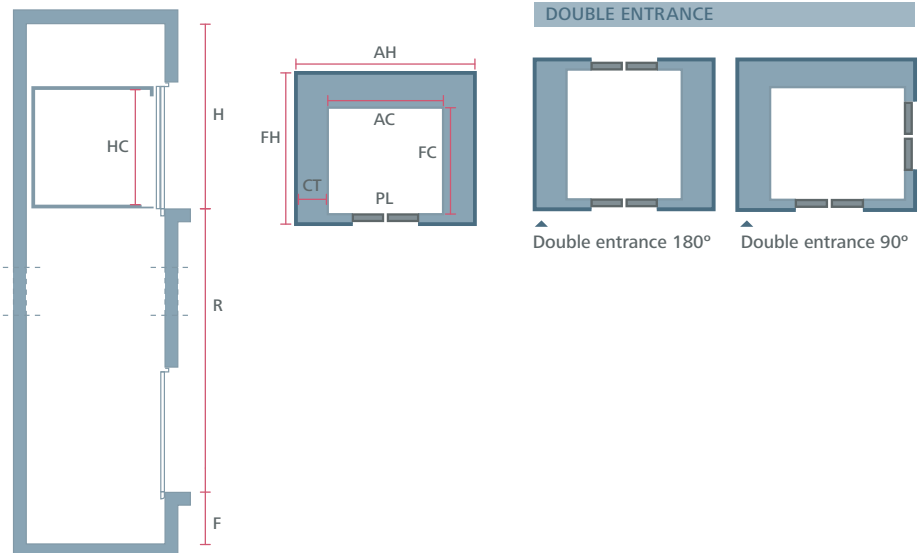

H minimum V=1m/s 3.400 mm (ND95/16)

H reduced 3.000 mm

Entrances: 90°, 180°

Options: Safety Gear in counterweight, Reduced Pit/Overhead

Tolerance AH:± 50mm

TECHNICAL SPECIFICATIONS

SERIES "S" MACHINE ROOM LESS

	MP610V	MP810V
P	6	8
V	1.0 m/s	1.0 m/s
AH	1600	1700
FH	1550	1700
AC	1000	1100
FC	1250	1400
CT	480	480
H	3800	3800
F	1200	1200
PL	800	800

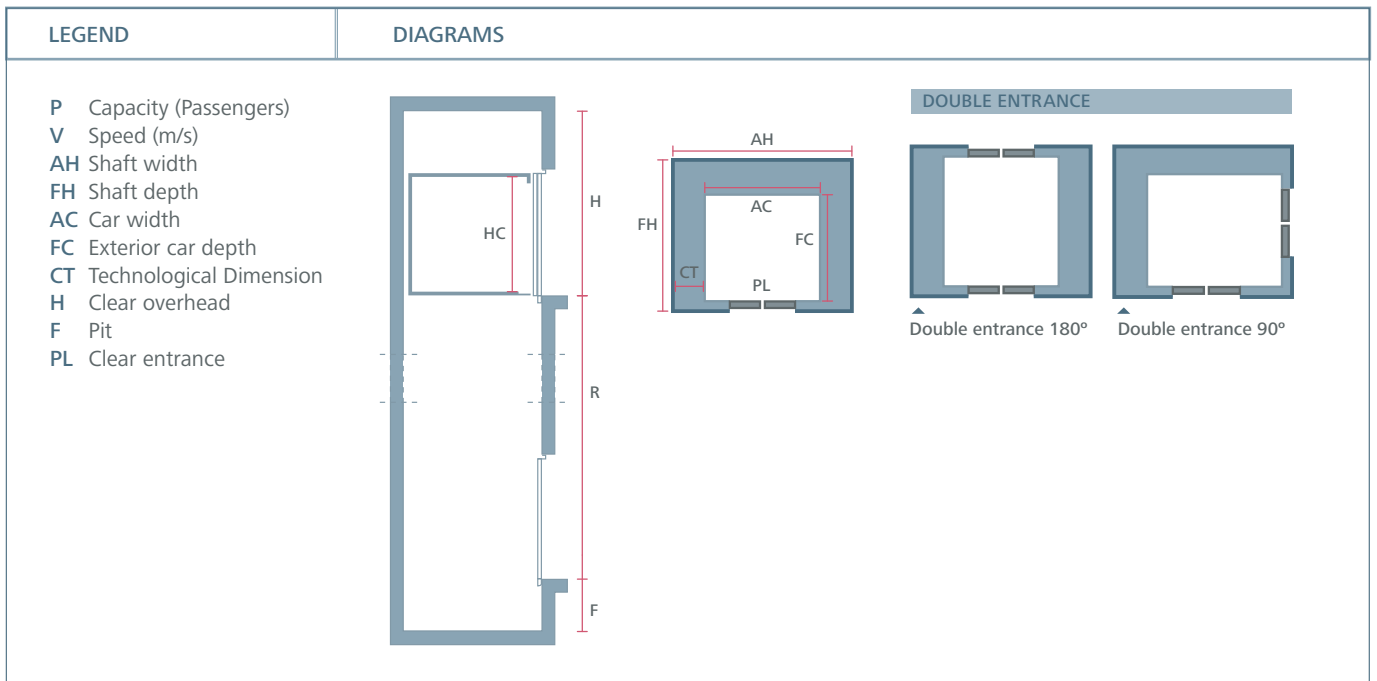

H minimum 3.700 mm (ND95/16)  
Entrances: 90°, 180°  
No options availables  
Tolerance AH:± 50mm

# MP|PASSENGERlift

## Traction Series "S"

Self supporting (A)Technology GO!  
6, 8 passengers

MP610GO! | MP810GO!  
MP616GO! | MP816GO!

### TECHNICAL SPECIFICATIONS

### SERIES "S" MACHINE ROOM LESS

	MP610GO!	MP810GO!	MP616GO!	MP816GO!
P	6	8	6	8
V	1.0 m/s	1.0 m/s	1.6m/s	1.6m/s
AH	1600	1700	1600	1700
FH	1550	1700	1600	1750
AC	1000	1100	1000	1100
FC	1250	1400	1250	1400
CT	350	350	350	350
H	3600	3600	3700	3700
F*	1050	1050	1250	1250
PL	800	800	800	800

#### LEGEND

- P Capacity (Passengers)
- V Speed (m/s)
- AH Shaft width
- FH Shaft depth
- AC Car width
- FC Exterior car depth
- CT Technological Dimension
- H Clear overhead
- F\* Pit
- PL Clear entrance

#### DIAGRAMS

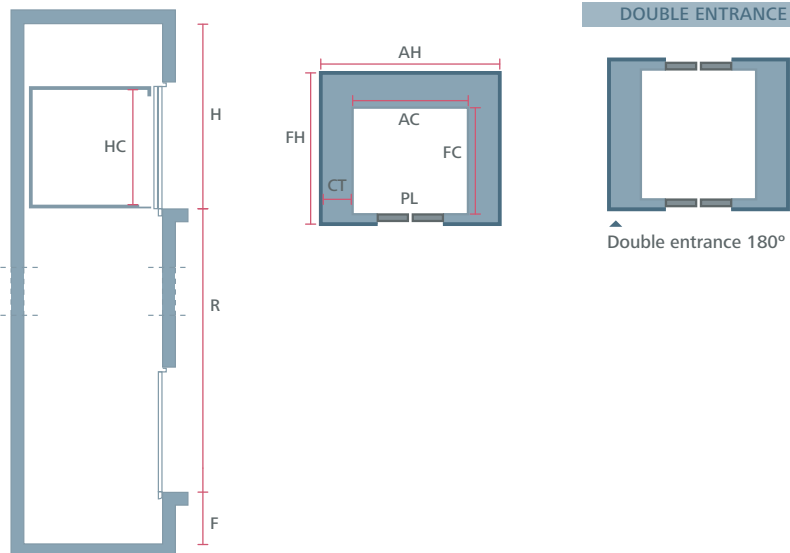

\*Minimum dimensions

H minimum 3.400 mm (ND95/16)

H reduced 3.000 mm

Entrances: 180°

Options: MP GO! Adapt and EN81-21 adaptation. On request.

Tolerance AH:+- 50mm

### TECHNICAL SPECIFICATIONS

### SERIES "S" MACHINE ROOM LESS

	MP610G 90	MP810G 90	MP616G 90	MP816G 90
P	6	8	6	8
V	1.0 m/s	1.0 m/s	1.6 m/s	1.6 m/s
AH	1600	1700	1600	1700
FH	1550	1700	1550	1700
AC	1000	1100	1000	1100
FC	1250	1400	1250	1400
CT	480	480	480	480
H	3600	3600	3800	3800
F	1200	1200	1400	1400
PL	800	800	800	800

#### LEGEND

- P Capacity (Passengers)
- V Speed (m/s)
- AH Shaft width
- FH Shaft depth
- AC Car width
- FC Exterior car depth
- CT Technological Dimension
- H Clear overhead
- F Pit
- PL Clear entrance

#### DIAGRAMS

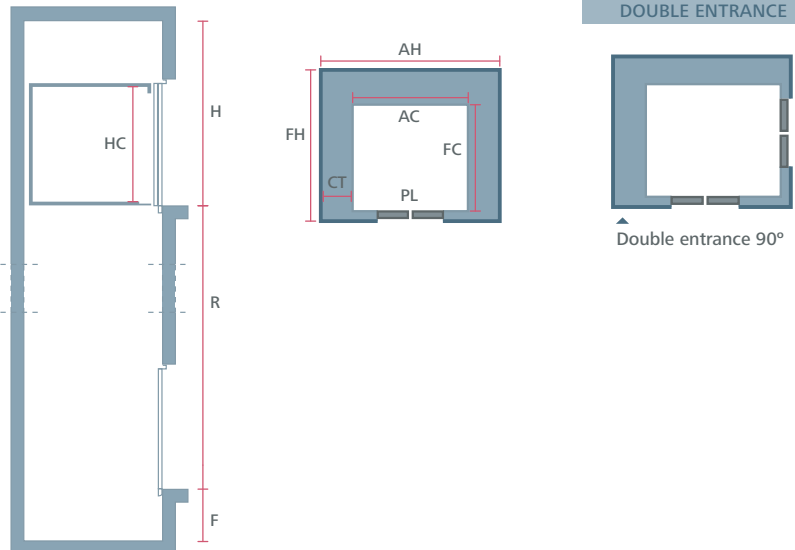

H minimum 3.400 mm (ND95/16)

H reduced 3.000 mm

Entrances: 90°

Options: safety Gear in counterweight, Reduced Pit/Overhead

Tolerance AH:± 50mm

TECHNICAL SPECIFICATIONS

SERIES "S" MACHINE ROOM LESS

	MP1010G	MP1310G	MP1016G	MP1316G
P	10	13	10	13
V	1.0 m/s	1.0 m/s	1.6 m/s	1.6 m/s
AH	1850	2050	1850	2050
FH	1800	1900	1800	1900
AC	1200	1400	1200	1400
FC	1500	1600	1500	1600
CT	520	520	520	520
H	3600	3600	3800	4000
F	1400	1400	1600	1600
PL	900	1000	900	1000

LEGEND

DIAGRAMS

- P Capacity (Passengers)
- V Speed (m/s)
- AH Shaft width
- FH Shaft depth
- AC Car width
- FC Exterior car depth
- CT Technological Dimension
- H Clear overhead
- F Pit
- PL Clear entrance

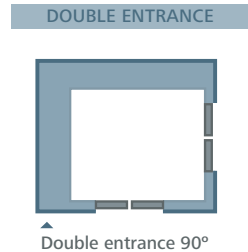
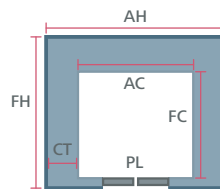
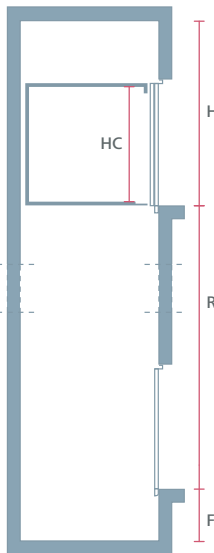

H minimum v=1m/s 3.400 mm (ND95/16)

H reduced 3.000 mm

Entrances: 90°

Options: safety Gear in counterweight, Reduced Pit/Overhead

Tolerance AH:± 50mm

# MP | PASSENGERlift

## Traction Series "S"

No Self supporting (NOA) Technology (G)  
10, 13 passengers

MP1010G 90 | MP13r10G 90  
MP1016G 90 | MP1316G 90

### TECHNICAL SPECIFICATIONS

### SERIES "S" MACHINE ROOM LESS

	MP1010G 90	MP13r10G 90	MP1016G 90	MP1316G 90
P	10	13	10	13
V	1.0 m/s	1.0 m/s	1.6 m/s	1.6 m/s
AH	1850	1750	1850	2050
FH	1800	2400	1800	1900
AC	1200	1100	1200	1400
FC	1500	2100	1500	1600
CT	490	545	520	520
H	3600	3600	3800	4000
F	1400	1200	1600	1600
PL	900	1000	900	1000

#### LEGEND

- P Capacity (Passengers)
- V Speed (m/s)
- AH Shaft width
- FH Shaft depth
- AC Car width
- FC Exterior car depth
- CT Technological Dimension
- H Clear overhead
- F Pit
- PL Clear entrance

#### DIAGRAMS

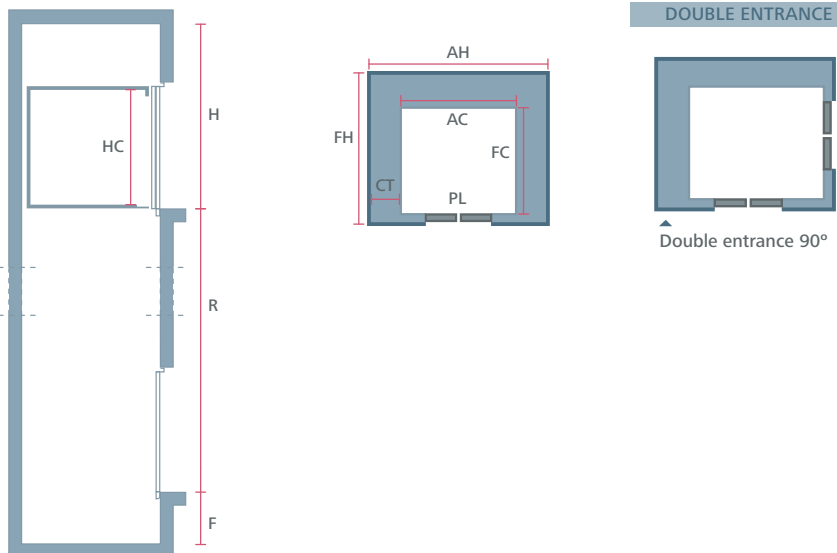

H minimum: v=1m/s 3.700 mm (ND95/16)  
H reduced 3.000 mm  
Entrances: 90°  
Options: safety Gear in counterweight  
Tolerance AH: +/- 50mm

### TECHNICAL SPECIFICATIONS

### SERIES "S" MACHINE ROOM LESS

	MP1010GO!	MP13r10GO!	MP1310GO!
P	10	13	13
V	1.0 m/s	1.0 m/s	1.0m/s
AH	1950	1750	1950
FH	1750	2350	2000
AC	1400	1100	1400
FC	1350	2100	1600
CT	380	380	380
H	3600	3600	3600
F*	1200	1200	1200
PL	800	800	800

#### LEGEND

- P Capacity (Passengers)
- V Speed (m/s)
- AH Shaft width
- FH Shaft depth
- AC Car width
- FC Exterior car depth
- CT Technological Dimension
- H Clear overhead
- F\* Pit
- PL Clear entrance

#### DIAGRAMS

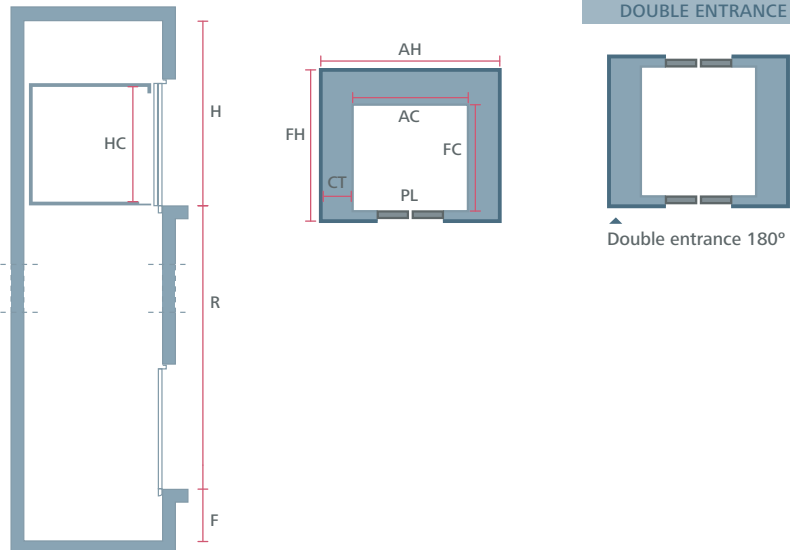

\*Minimum dimensions

H minimum 3.400 mm (ND95/16)

H reduced 3.200 mm

Entrances: 180°

Options: MP GO! Adapt and EN81-21 adaptation. On request.

Tolerance AH:± 50mm